

SERVOX

PREFORM DUMPER

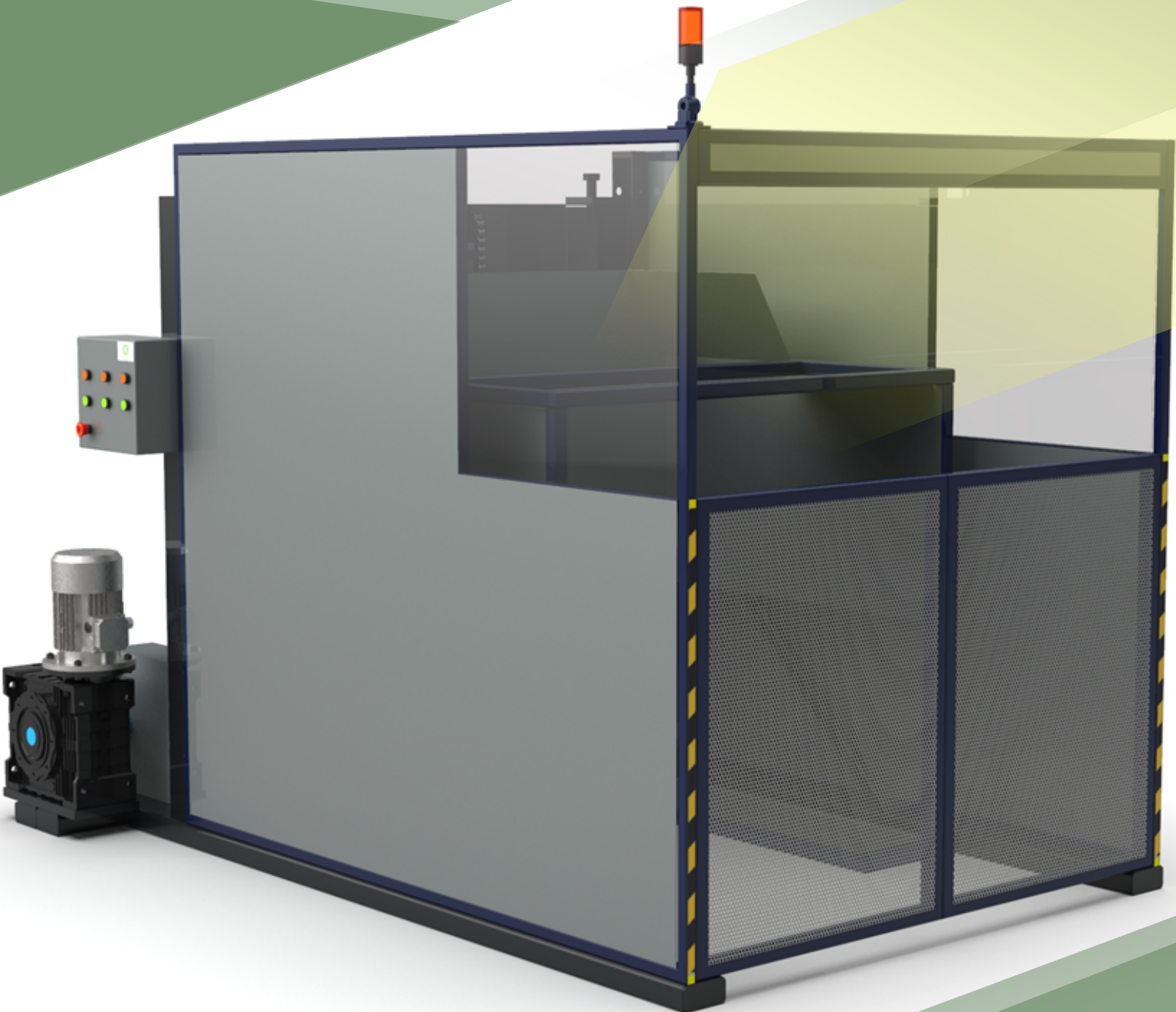

A **SERVOX Dumper** enables easy loading of PET Preforms into the hopper of a Stretch Blowing Machine

WHY SERVOX ?

- **Energy saving.** Being a mechanical dumper it consumes less energy as compared to air or hydraulic dumpers of the same capacity.
- **Ease of set up.** The setting up of the Dumper is easy as it does not require accessories like Hydraulic Powerpack or compressor.
- Can be Integrated with machine to increase the overall efficiency.
- They provide a **Safe, Clean** and **Silent Environment** compared to hydraulic and pneumatic dumpers.

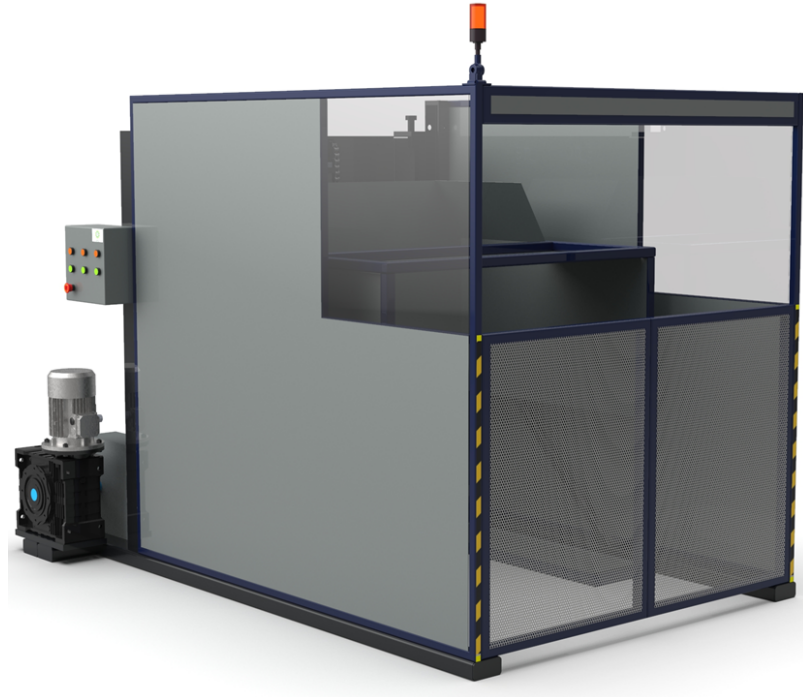

For today's high speed machines large quantities of preforms are brought packed in large cardboard boxes called "GAYLORDS". Typically a gaylord may contain 12000-30000 preforms and weigh as much as 350-500kg making it difficult to transfer the preforms in to the machine's hopper manually. This machine can also be used, where preforms are brought in jumbo plastic bags or Woven Sacks.

The Preform Dumper lifts the gaylord and tilts it to drop the preforms into the hopper thereby saving manpower and stoppages due to lack of preforms in the hopper.

The machine consists of a sturdy floor mounted frame and a bin at floor level, large enough to hold the gaylord. A person brings the gaylord on a forklift or trolley and slides it into the bin and closes the safety gate. When a command is given by either a person or machine itself, the bin is raised, tilted to drop the preforms in to the machine hopper and return to home position ready for the next loading.

MODES OF OPERATION

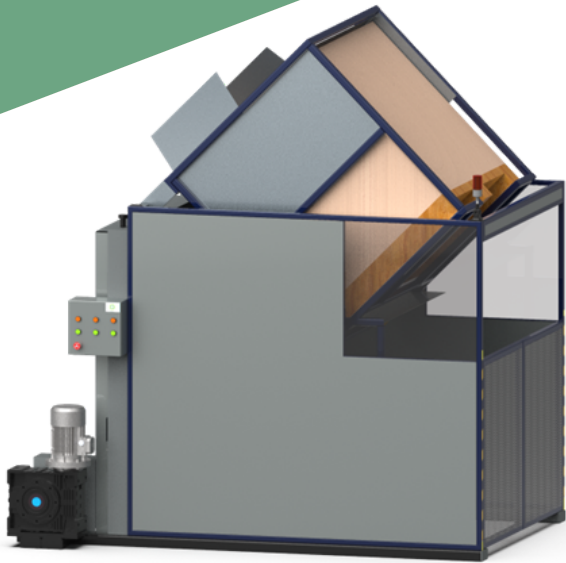

MANUAL

A person loads the gaylord onto the Bin and closes the safety gate. He pushes a button to raise and tilt the bin to drop the preforms in the machine hopper and lowers it using another push button. The entire cycle is independent of the Control system.

SEMI AUTOMATIC

A person loads the gaylord into the Bin, closes the safety gate. When he decides to load the preforms in to the hopper, he merely presses "START" button and the full cycle takes place through the Control panel.

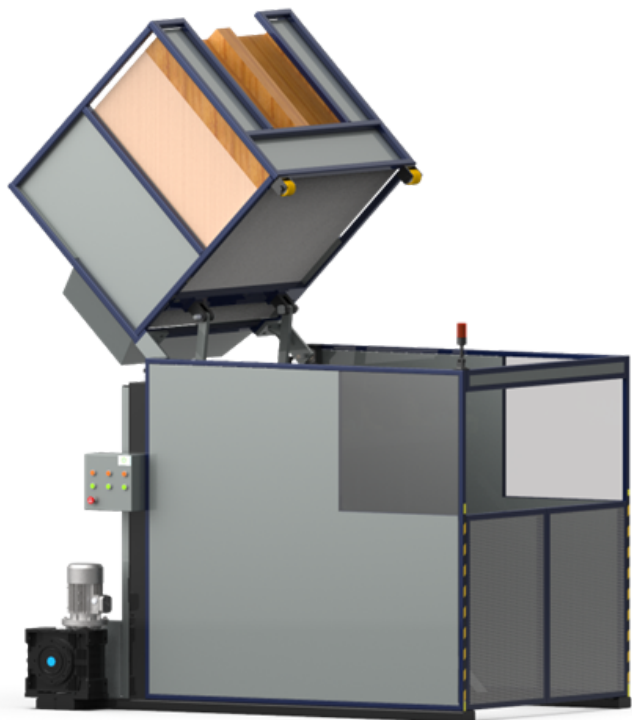

Fully Automatic (Optional)

Same as above but instead of a person starting the cycle, the machine waits for signal from a "Preform low Level Sensor" mounted into the hopper of the machine. On receiving the signal it completes the cycle and returns to home position ready for the next loading.

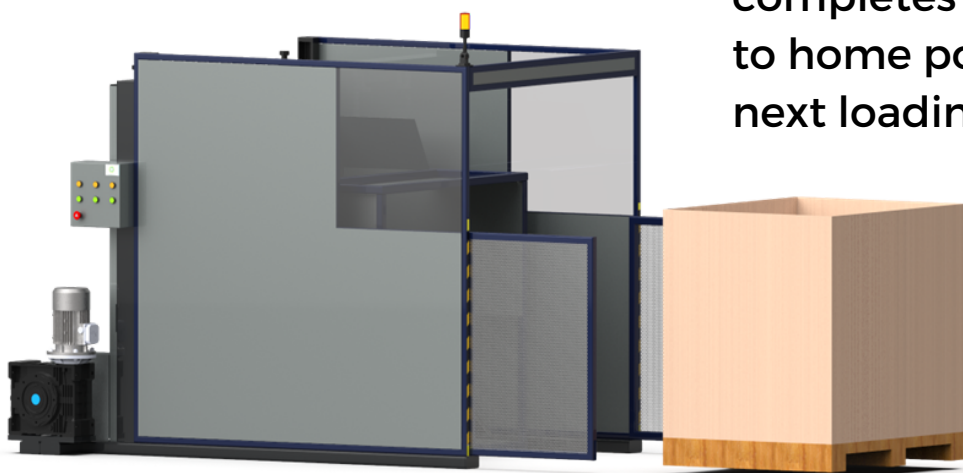

SERVOX

PD 1.5

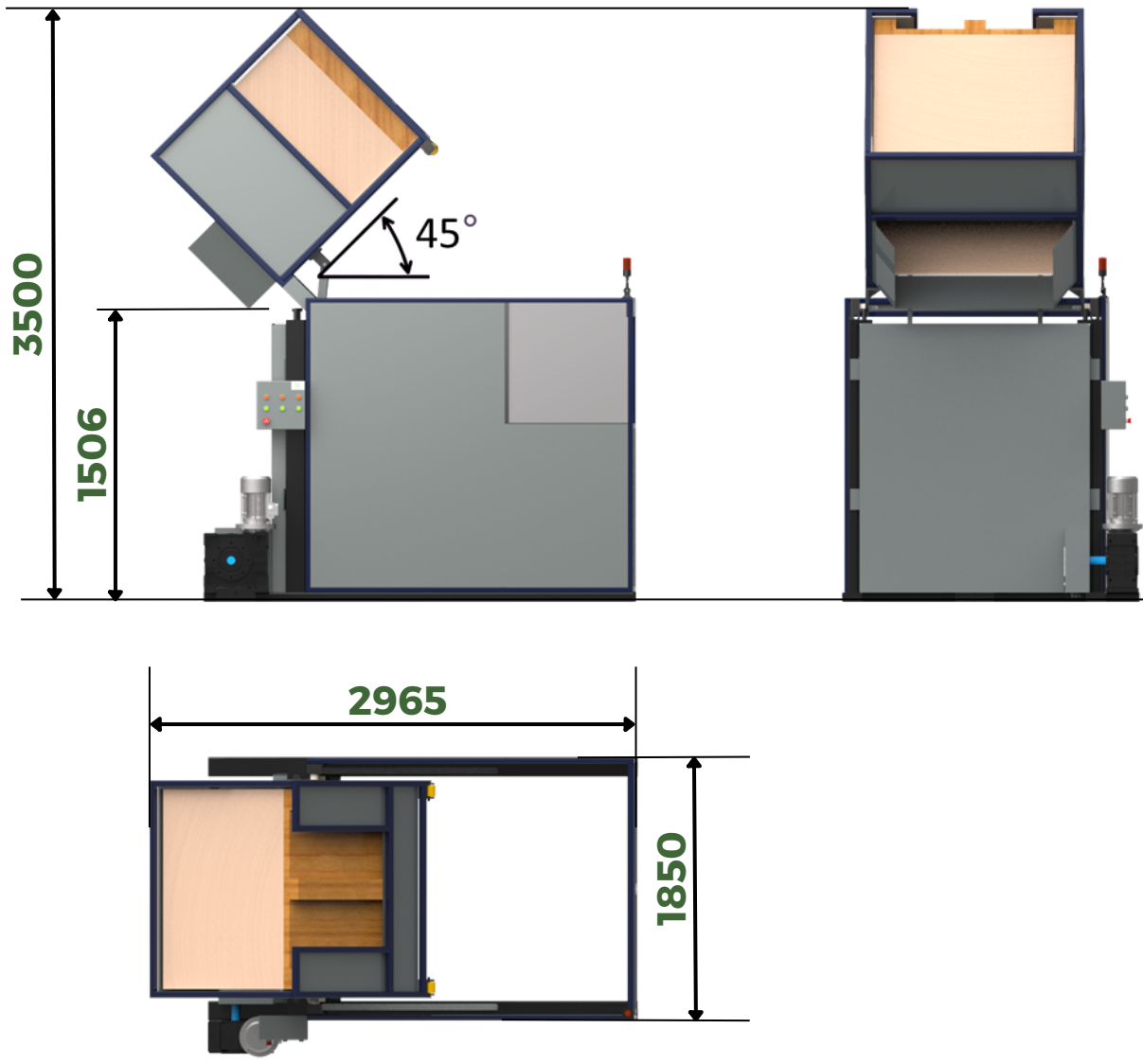

SAFETY	DOOR LOCKING SWITCHES	
	ELECTRICAL MUSHROOM LOCKS	
	MECHANICAL LOCKS	
GAYLORD DIMENSIONS	PAYLOAD	500 KG
	(GAYLORD WEIGHT)	
	HEIGHT	1190 MM
	LENGTH	1020MM
	WIDTH	1230MM
MACHINE DETAILS	TOTAL MACHINE WEIGHT	1350 KG
	MOTOR	3HP
	POWER	3PHASE 440V
	PLC & CONTROLS	

SERVOX

PD 1.8

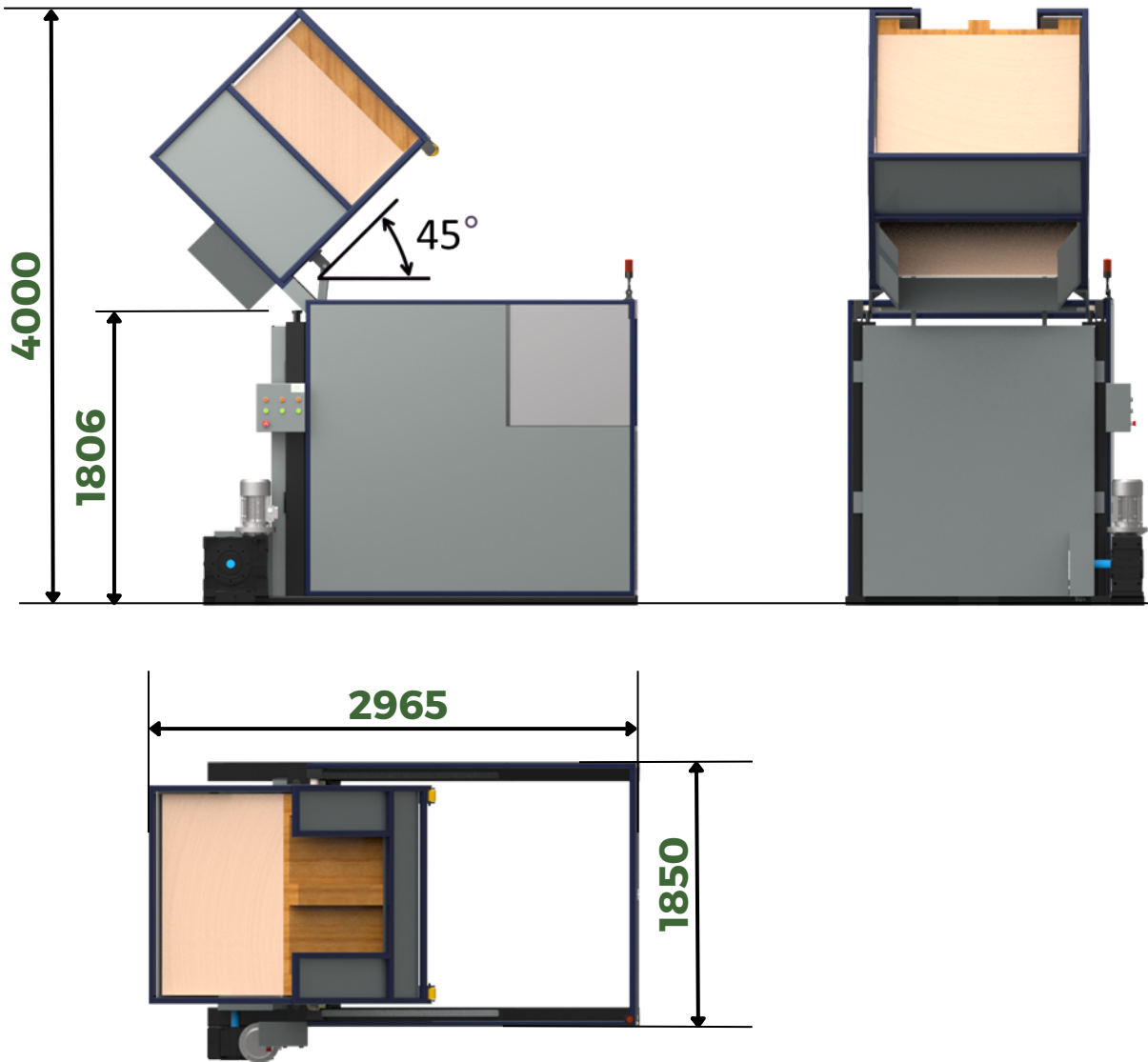

SAFETY	DOOR LOCKING SWITCHES	
	ELECTRICAL MUSHROOM LOCKS	
	MECHANICAL LOCKS	
GAYLORD DIMENSIONS	PAYLOAD	500 KG
	(GAYLORD WEIGHT)	
	HEIGHT	1190 MM
	LENGTH	1020MM
	WIDTH	1230MM
MACHINE DETAILS	TOTAL MACHINE WEIGHT	1350 KG
	MOTOR	3HP
	POWER	3PHASE 440V
	PLC & CONTROLS	

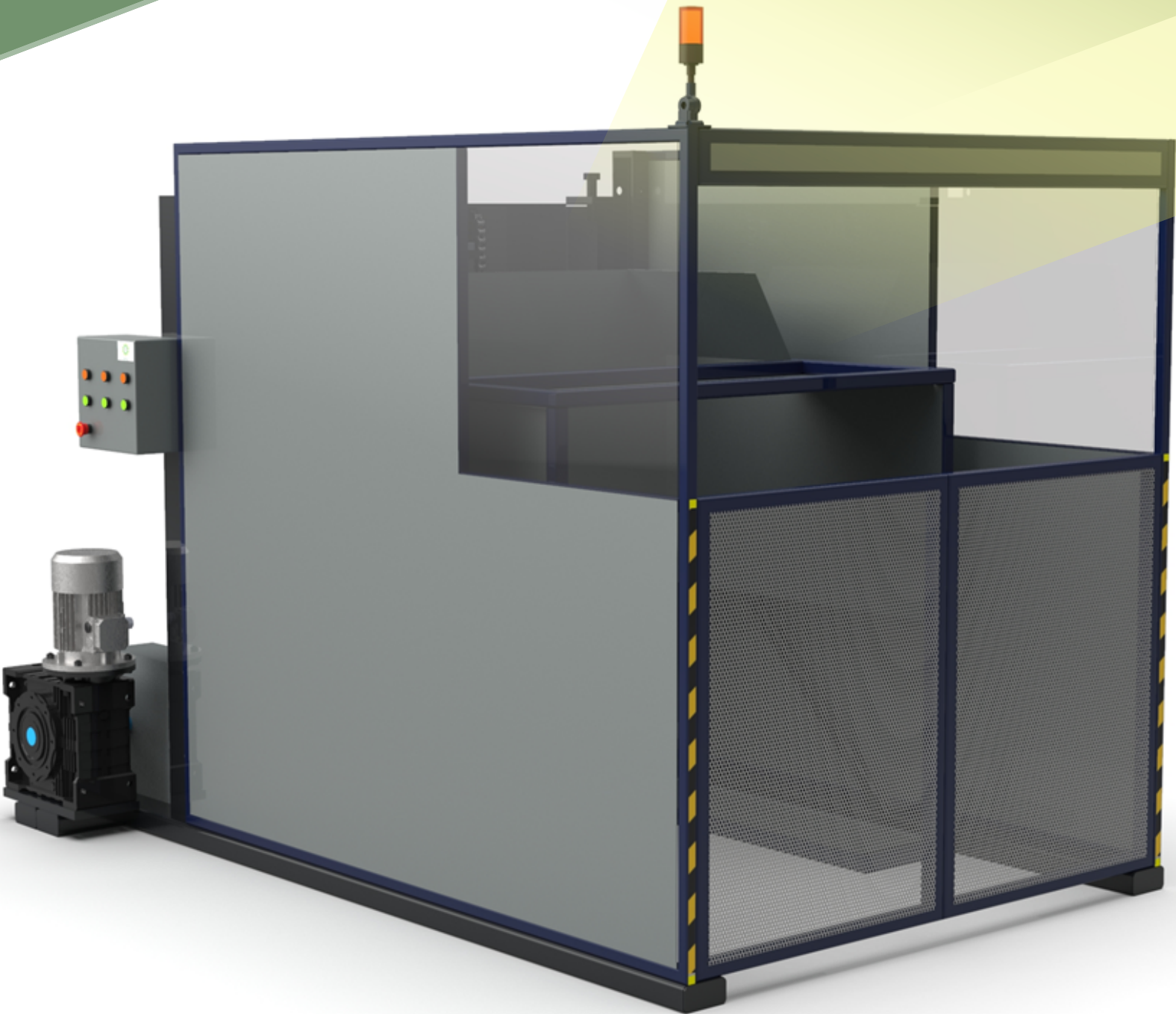

SERVOX IS A BRAND OF BIOPLAST

 +91-98203 54162

 +91-8169 317784

 www.servoxsystems.com

 sales@servoxsystems.com